

LOW VOLTAGE TUBING

SUPER SEAL TUBING



Super Seal Low Voltage adhesive lined tubing is available in both medium and heavy wall sizes. Medium wall tubes (series GMW) are used for environmental protection of low voltage cable terminations and insulating connectors for low voltage straight through joints, splices and jacket repairs up to 1.1KV. Heavy wall tubes (series GHW) are used for mechanical protection and outer sealing of underground straight through cable joints, splices and jacket repairs up to 36KV. They both have excellent resistance to weathering, UV rays, chemicals and solvents and conform to the IEC 60684-3-247 standard and are available in multiple lengths and diameters from 1/2" up to 7.8"

TECHNICAL SPECIFICATIONS

PROPERTIES	VALUE	STANDARD
MECHANICAL		
Tensile Strength Test	13 MPa (1885.5 psi)	ASTM D638
Ultimate Elongation (Min)	350%	ASTM D638
Density	1.03 +/- 0.2 gm/cm ³	ASTM D792
Hardness	50 +/- 10 Shore D	ASTM D2240
Water Absorption (Max)	0.18%	ASTM D570
Specific Gravity (Max)	1.05	ASTM D792
THERMAL		
Accelerated Aging (500 Hours)	120°C (248°F)	ASTM D2671
Tensile Strength (Min)	11 MPa (1595 psi)	ASTM D638
Ultimate Elongation (Min)	300%	ASTM D638
Heat Distortion @ 150°C (302°F)	2%	ASTM D1047
Low Temperature Flexibility -40°C (-40°F) for 4 Hrs.	No Cracking	ASTM D2671
Heat Shock 250°C (482°F) for 30 Min.	No Cracking or Flowing	ESI 09-11
Shrink Temperature	125°C (257°F)	IEC 216
Continuous Temperature Limit	-40 to 100°C (-40 to 212°F)	IEC 216
ELECTRICAL		
Dielectric Strength (Min)	18 KV/mm (457.2 KV/in)	ASTM D149
Volume Resistivity (Min)	5 x 10 ⁻¹⁴ Ohm.cm	ASTM D257
Dielectric Constant @ 60 Hz (Max)	4.0 pf	ASTM D150
CHEMICAL		
Ozone Resistance - 48 hrs @ 0.03	No Cracking	
SOLVENT RESISTANCE TEST		
Tensile Strength Test	11.5 MPa (1668 psi)	ASTM D257
Elongation Test	325%	ASTM D257
Di-Electric Test (Min)	15 KV/mm (381 KV/in)	ASTM D257
CORROSION TEST		
Tensile Strength Test	11.5 MPa (1668 psi)	ESI 09-13
Elongation Test	325%	ESI 09-13

DIMENSIONAL DATA

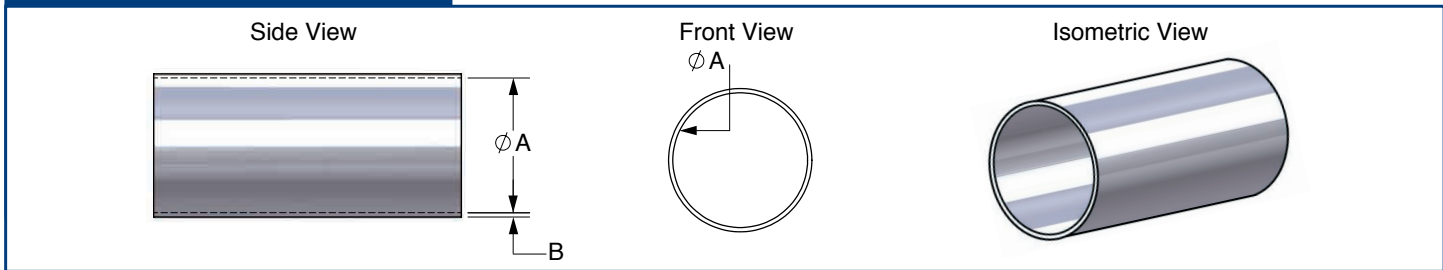

MEDIUM WALL TUBING SELECTION CHART

Super Seal Part #	Inside Diameter "A"				Wall Thickness "B"		Cable Range		
	Supplied		Recovered		Recovered (+/- 20%)		Size	Diameter	
	(mm)	(inches)	(mm)	(inches)	(mm)	(inches)	AWG KCML	(mm)	(inches)
GMW 10/3	10	0.39	3	0.12	1.00	0.04	#14 - #8	3 - 9	0.11 - 0.35
GMW 12/4	12	0.47	4	0.15	1.50	0.06	#12 - #6	4 - 10	0.15 - 0.39
GMW 19/6	19	0.75	6	0.23	2.00	0.08	#8 - #3	6 - 16	0.23 - 0.62
GMW 27/8	27	1.06	8	0.31	2.50	0.09	#2 - 2/0	9 - 25	0.35 - 0.98
GMW 40/12	40	1.57	12	0.47	2.50	0.09	1/0 - 250	13 - 38	0.51 - 1.49
GMW 51/16	51	1.97	16	0.63	2.50	0.09	300 - 500	21 - 48	0.82 - 1.88
GMW 70/22	70	2.75	22	0.86	2.50	0.09	600 - 1250	24 - 68	0.94 - 2.67
GMW 90/28	90	3.54	28	0.98	2.50	0.09		29 - 88	1.14 - 3.46
GMW 115/34	115	4.52	34	1.33	3.00	0.11		32 - 112	1.25 - 4.40
GMW 130/36	130	5.11	36	1.47	3.00	0.11		34 - 128	1.33 - 5.03
GMW 140/42	140	5.51	42	1.65	3.00	0.11		44 - 138	1.73 - 5.43
GMW 160/50	160	6.29	50	1.97	3.00	0.11		45 - 155	1.77 - 6.10
GMW 180/60	180	7.08	60	2.36	3.00	0.11		57 - 175	2.24 - 6.88
GMW 200/70	200	7.87	70	2.75	3.30	0.13		65 - 190	2.55 - 7.48

HEAVY WALL TUBING SELECTION CHART

Super Seal Part #	Inside Diameter "A"				Wall Thickness "B"		Cable Range		
	Supplied		Recovered		Recovered (+/- 20%)		Size	Diameter	
	(mm)	(inches)	(mm)	(inches)	(mm)	(inches)	AWG KCML	(mm)	(inches)
GHW 13/4	13	0.51	4	0.15	2.4	0.09	#12 - #6	4 - 10	0.15 - 0.39
GHW 20/6	20	0.78	6	0.23	2.5	0.10	#8 - #2	6 - 18	0.23 - 0.70
GHW 33/8	33	1.29	8	0.31	3.0	0.12	#4 - 4/0	9 - 25	0.35 - 0.98
GHW 40/12	40	1.57	12	0.47	4.1	0.16	1/0 - 400	13 - 38	0.51 - 1.49
GHW 51/16	51	2.00	16	0.63	4.1	0.16	250 - 500	18 - 45	0.70 - 1.77
GHW 70/22	70	2.75	22	0.86	4.1	0.16	600 - 1250	24 - 65	0.90 - 2.55
GHW 85/25	85	3.34	25	0.98	4.1	0.16	800 - 1200	29 - 88	1.14 - 3.46
GHW 105/30	105	4.13	30	1.18	4.1	0.16	800 - 1250	33 - 94	1.30 - 3.70
GHW 120/38	120	4.72	38	1.49	4.1	0.16	1500 - 2500	34 - 128	1.33 - 5.03
GHW 140/42	140	5.51	42	1.65	4.1	0.16		44 - 138	1.73 - 5.43
GHW 160/50	160	6.29	50	1.96	4.3	0.17		45 - 155	1.77 - 6.10
GHW 180/55	180	7.08	55	2.16	4.3	0.17		57 - 175	2.24 - 7.89
GHW 200/65	200	7.87	65	2.55	4.3	0.17		65 - 190	2.55 - 7.48